

HB SERIES

SPST, SPDT ROCKER SWITCHES UP TO 20A 125VAC, IP42 RATING, T125
classical outlook, crystal lighting, 6A "L", splash protected



Snap-in Panel Cutout
X=Panel Thickness

X	A		B		C	
	Dim.Y	Dim.Z	Dim.Y	Dim.Z	Dim.Y	Dim.Z
0.75 to 1.25	28.6+0/-0.1	13.8	28.6+0/-0.1	12.1	28.6+0/-0.1	13.4
1.25 to 2	28.8+0/-0.1	13.8	28.8+0/-0.1	12.1	28.8+0/-0.1	13.4
2 to 3	29.2+0/-0.1	13.8	29.2+0/-0.1	12.1	29.2+0/-0.1	13.4

#Two Color Rocker available; Consult the factory for "L" rating up to 90A inrush



- Double shot rocker available, visi color
- Classical outlook, full or soft lighting
- 20A 125VAC / 16A 250VAC (UL,CSA)
- 3/4 HP 125VAC, 3/4 HP 250VAC (CSA)
- 6A 125VL, 3/4HP 250VAC(UL)
- 16(4) A 250VAC~T125 (VDE,SEMKO,DEMKO,NEMKO, FIMKO,SEV)
- 16A 250VAC (CQC)
- Initial contact resistance : 20m ohm max.
- Insulation resistance : 100M ohm min, at 500VDC

- Dielectric strength : 1,000VAC for 1 minute
- Electrical life : 10,000 cycles
- Temperature range : -20 to +125 degrees in Celsius
- Switch for Class II appliances
- Base : Nylon 66, UL rated 94V-2 min
- Actuator : Nylon 66 or PC, UL rated 94V-2 min
- Spring : Piano wire
- Contacts : Silver alloy
- Terminals : Silver plated copper
- Lamp : Neon

[See How to order](#)



HB110-C2L-BRN-A

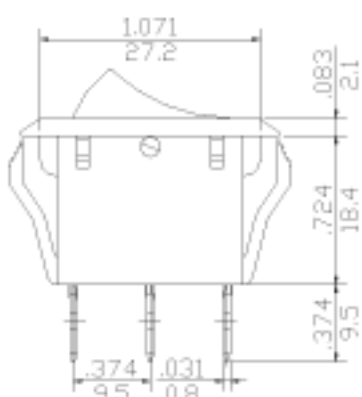
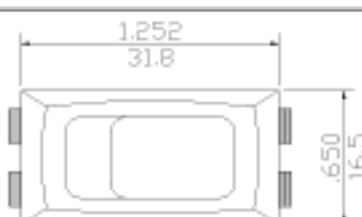

HB110-C2N-BBG-A

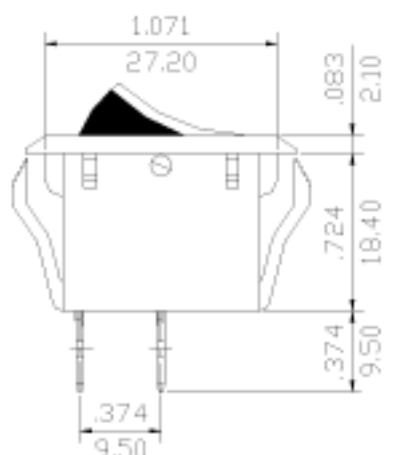
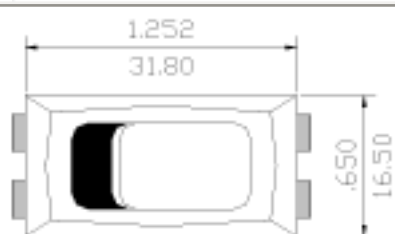

HB180-C2N-BBN-M

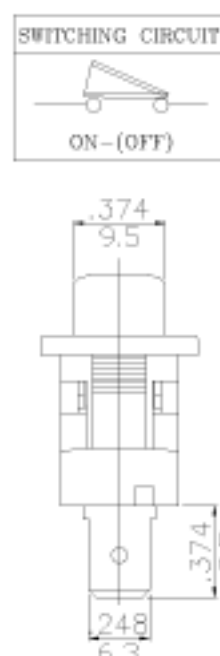
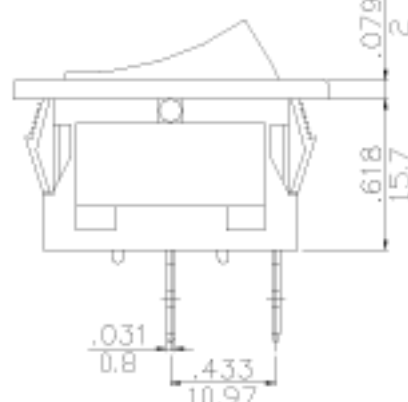
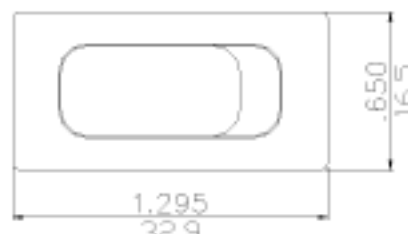

HB130-C8N-BRN-W

